

# MCVS16 SILENT CHECK VALVE

# MATE

## Technical Specifications

Specification	Description
Nominal Pressure	16bar
Shell Test Pressure	24bar
Seal Test Pressure	17.6bar
Working Temperature	0°C ≤ T ≤ 80°C
Working Medium	Water
Design Standard	EN 12334
Flange Standard	EN 1092-2 PN16



## Materials

No.	Part	Material
1	Guide	Ductile Iron
2	Body	Ductile Iron
3	Stem	Stainless Steel
4	Spring	SS316
5	Seal	EPDM
6	Disc	Ductile Iron

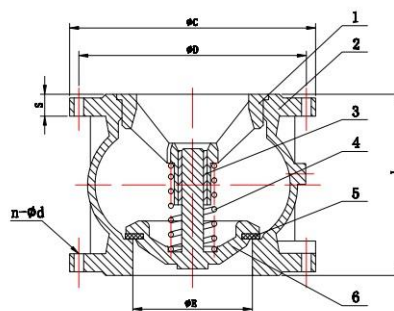

## Dimensions (mm)

DN	L	øE	øC	øD	N-ød	S
50	100	50	165	125	4-19	17
65	120	65	185	145	4-19	17
80	140	80	200	160	8-19	19
100	170	101	220	180	8-19	21
125	200	127	250	210	8-19	23
150	230	145	285	240	8-23	23
200	301	194	340	295	12-23	27
250	370	245	405	355	12-28	29
300	410	300	460	410	12-28	29
350	473	344	520	470	16-28	30