

MBF16 FULL LUG BUTTERFLY VALVE

Technical Specifications

Specification	Description
Body Design	Full Lug
Nominal Pressure	16bar
Shell Test Pressure	24bar
Seal Test Pressure	17.6bar
Working Temperature	-10 °C ≤T≤ 100 °C
Working Medium	Water, Oil, Gas
Design Conforms to	API609/BS 593/ BS 5155
Flange Standard	EN 1092-2 PN16
Inspection & Test	API598



Materials

No.	Part	Material
1	Body	Ductile Iron
2	Stem	SS410* SS420 SS431
3	Disc	Ductile Iron* SS304 SS316 Aluminium Bronze
4	Seat	EPDM
5	Bushing	Polymer
6	O-Ring	EPDM
7	Lever	Aluminium
8	Worm Gear	Ductile Iron
* Standard Material		



MBF16 FULL LUG BUTTERFLY VALVE

MATE

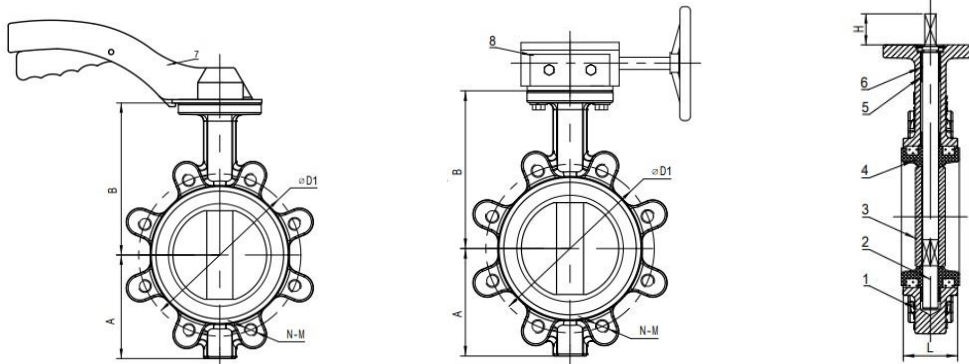

Dimensions (mm)

DN	L	B	A	S	H	øD1	N-ød
50	42	157	80	9	25	125	4-M16
65	45	172	89	9	25	145	4-M16
80	45	177	95	9	25	160	8-M16
100	52	199	116	11	28	180	8-M16
125	55	213	127	14	28	210	8-M16
150	55	226	139	14	28	240	8-M20
200	60	260	175	17	35	295	12-M20
250	67	292	210	22	40	355	12-M24
300	77	337	242	22	40	410	12-M24
350	78	372	268	22	40	470	16-M24
400	86	400	304	27	50	525	16-M27
450	103	411	337	27	50	585	20-M27
500	127	460	390	32	65	650	20-M30
600	154	523	442	36	70	770	20-M33
700	165	560	510	46	70	840	24-M33
800	190	635	585	46	80	950	24-M36